

Please read the manual carefully before using the video light

### Component

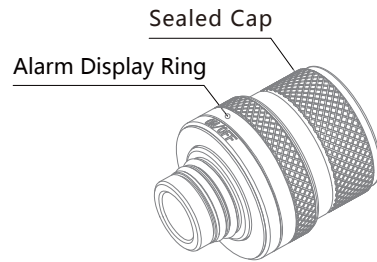

### Unpacking

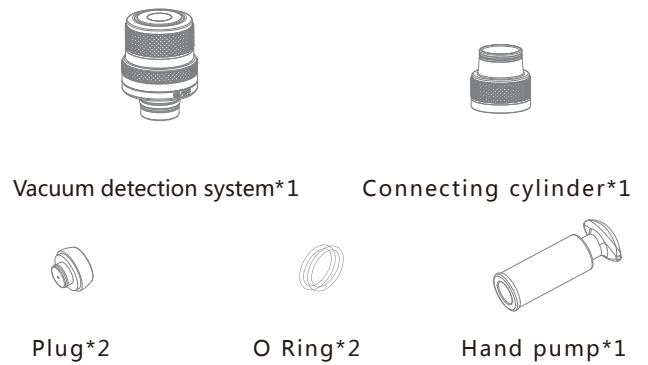

### To install the battery

1. Turn the sealed cap counter-clockwise to open.
2. Loading the Button batteries into the Battery compartments (Notice the positive and negative)
3. Turn the sealed cap clockwise to reattach the Vacuum detection system.

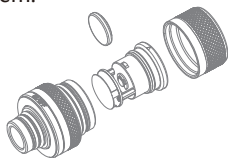

### Operating Instructions

#### Turn ON / Turn OFF :

Open the Vacuum detection system, Touch the laser ON/OFF position of it with the top of the sealed cap, and the red flash of the ring will be ON, Touch again it will be OFF (red flash off)

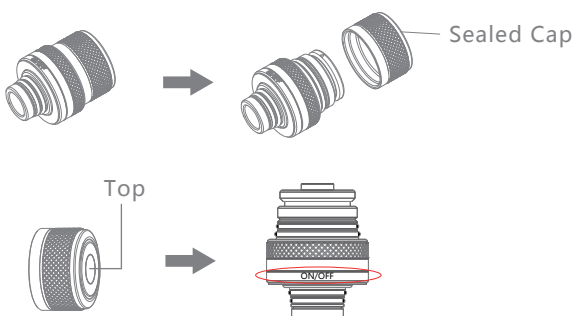

### Using the vacuum system :

- Install the Vacuum detection system on the waterproof shell, install The connecting cylinder, and then install the plug and use the hand pump for suction;

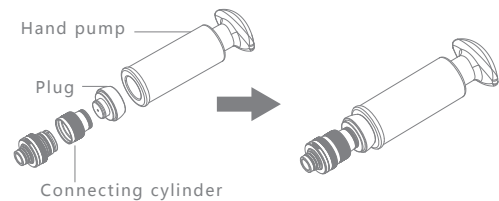

- When pumping, the alarm display ring will flicker red and green lights alternately,
- Stop pumping when the green light flashes, pull out the pump connection and cover the sealed cap of the Vacuum detection system.

- Before pumping (air leakage or no pumping), the red light is flashing
- Red and green lights flicker alternately when pumping
- The green light after pumping is flashing

